

Pot collar to suit the diameter
made from 40 x 40 x 3 mm angle iron
Stainless steel if welded to pot,
mild steel if clamped to pot

Provide bolts as needed to clamp it
to the pot.

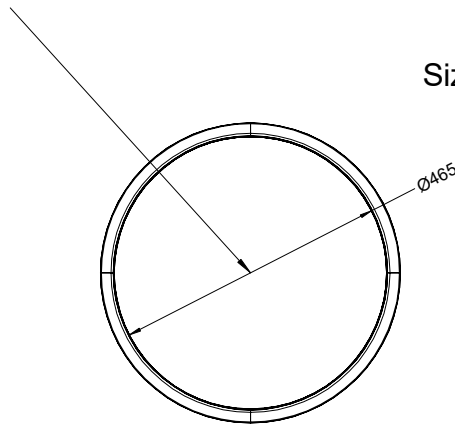

Size when clamped

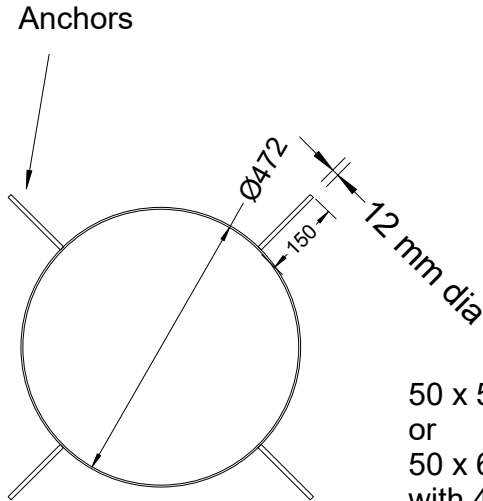

50 x 5 mm flat bar
or
50 x 6 mm flat bar
with 4 anchor rods
of Y12 Re-bar

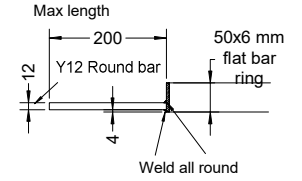

Pot support ring with
an I.D. at least 8mm larger
than the O.D of the pot

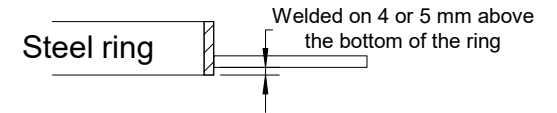

The radial arms are to provided
anchors for the steel ring. There
can be more than 4. They
should not be shorter than 150 mm.

For example:

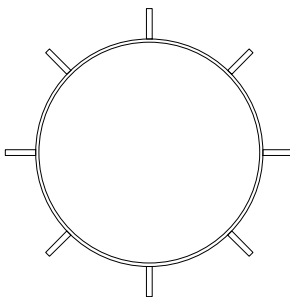

Steel Ring and Pot Collar

2024 MEMD 50 LITRE STOVE

Key Features:

Primary air is supplied between the bricks
under the fuel

Bricks block direct exit of gases

Brick combustion chamber

Material: Brick and High temperature brick

Quantity: Various

Scale: Not to scale

Version: 1.4 Date: 2024-12-17 Initials: CPP

Drawn By: C Pemberton-Pigott

Drawing No. 16 MEMD 50 Litres - Steel ring and collar

Part: Steel ring and pot collar